

ITEM	QTY.	PART NUMBER	MATERIAL	ASSEMBLY MATERIAL	MATERIAL THICKNESS	DESCRIPTION	
1	1	11858	304	Stainless Steel	12GA	18 X18 X12D FLOOR SINK 4" SCH10 - WELDMENT	
2	1	16868	1/8 IN PERF	Stainless Steel	14 ga	BASKET 15.25 X 15.25 X 6D	
3	3	15240		Stainless Steel	7 ga-3/16"	BANDED BAR GRATE	TDA-CVFS-18X06

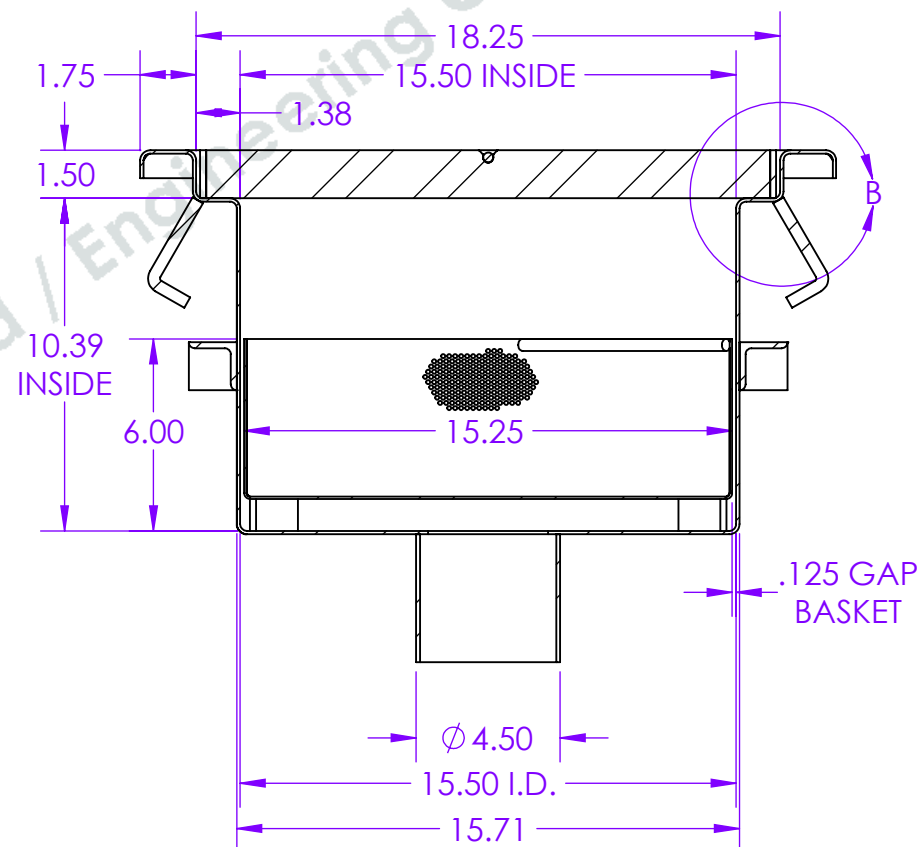

SECTION A-A
SCALE 1 : 6

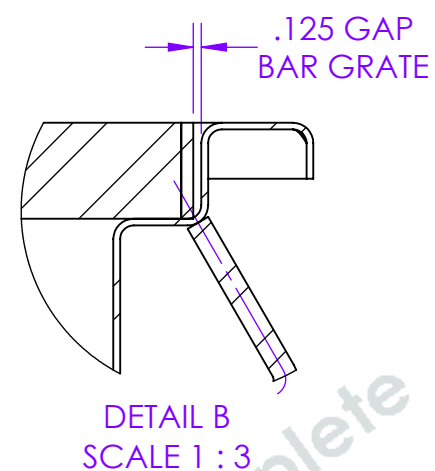
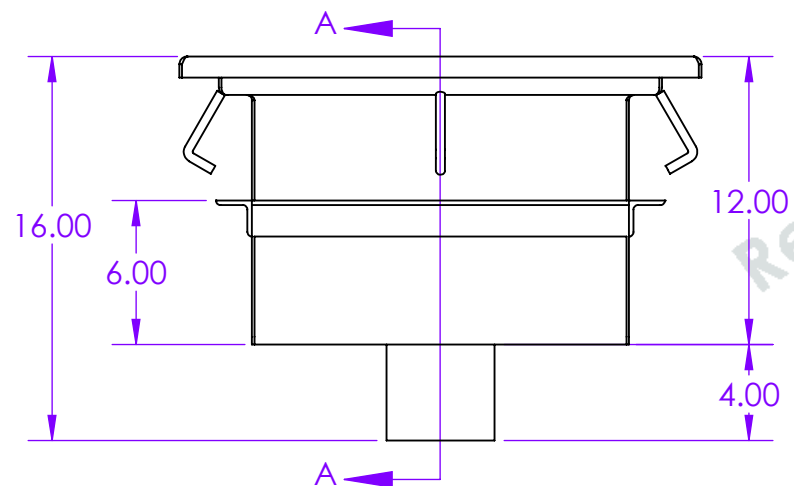
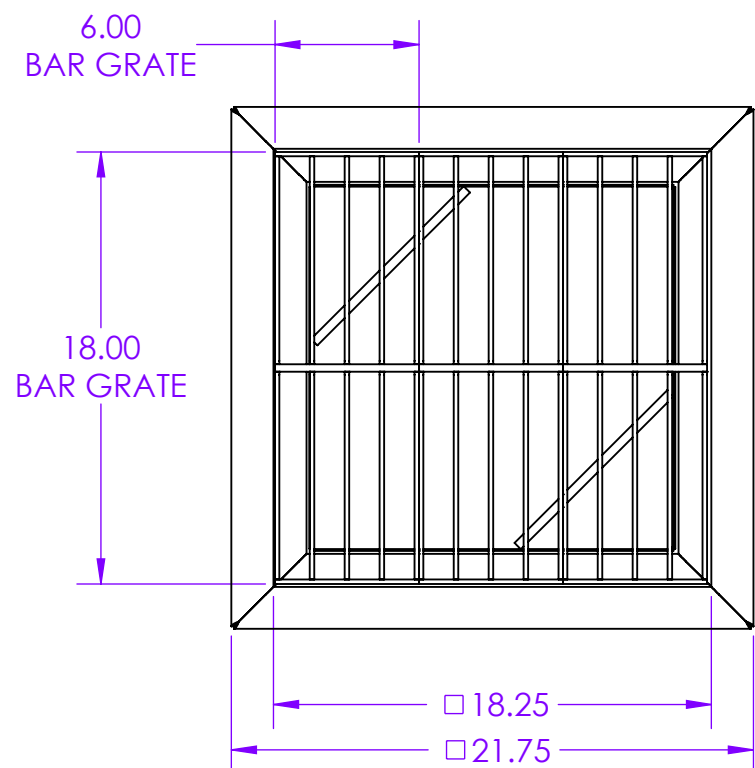
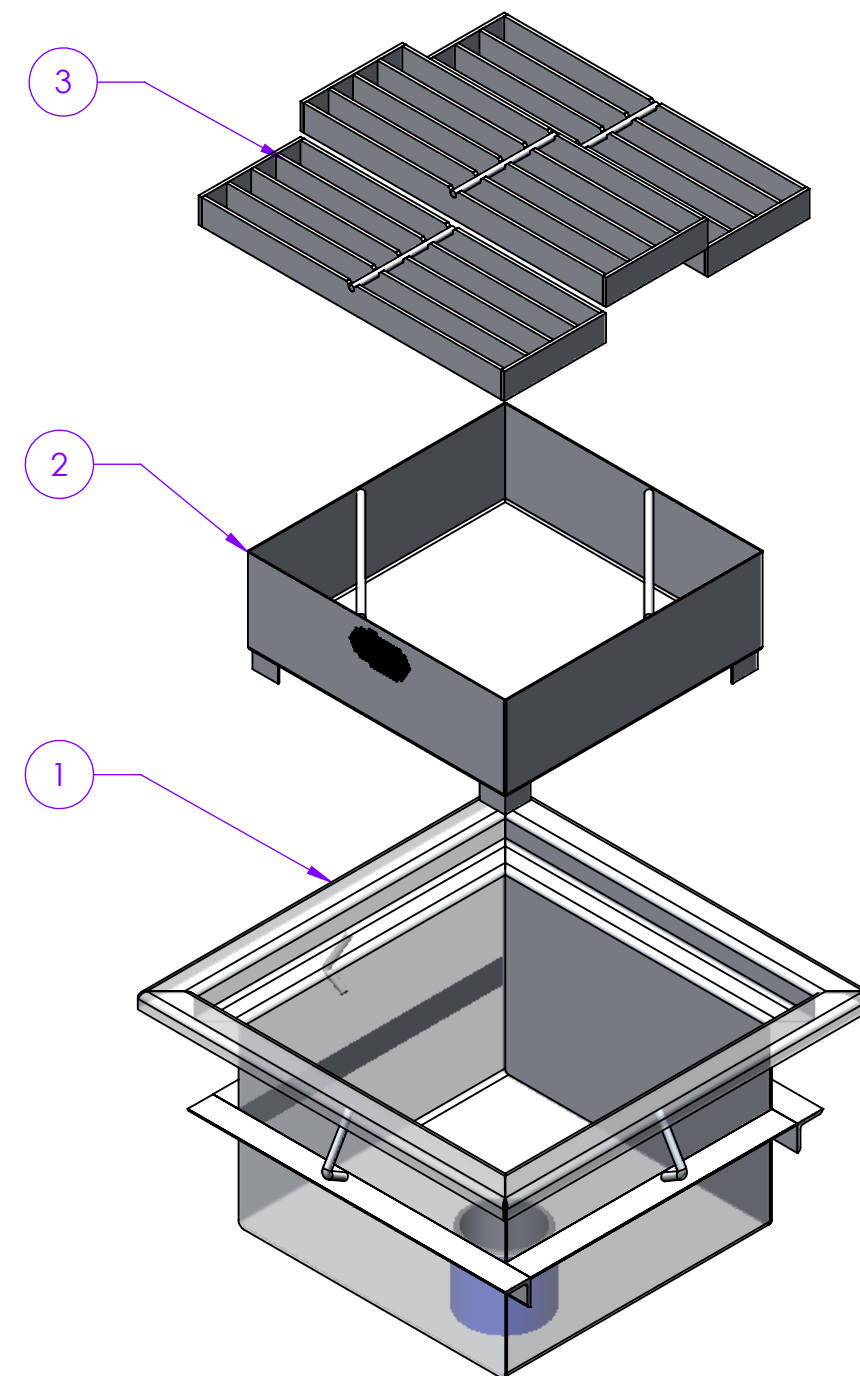

NOTES:

CONSTRUCTION

- *BODY 12GA T304 2B
- *4" SCH10 T304 PIPE OUTLET (BOTTOM OUTLET)
- *T304 CEMENT ANCHORS
- *T304 ANGLE PERIMETER STIFFENERS
- *INSIDE WELD DISCOLORATION REMOVED, O.S. DISCOLORATION TO REMAIN
- *OUTLET STRAINER INCLUDED

GRATING

- *3/16" X 1-1/2" LOAD BANDED BARGRATING W/1 5/16" SUPPORT ROD (NOT CONTINUOUSLY WELDED) PER SPEC T304 SS

NOTES UNLESS OTHERWISE SPECIFIED:

- ALL WELDS TO BE CONTINUOUS
- REMOVE ALL BURRS AND SHARP EDGES
- NO PITS, CRACKS OR HOLES ALLOWED IN WELDS

Revision Table				
DATE	BY	REV.	VER.	DESCRIPTION

TAG	Pearson Potts - Custom Drains 270 Bellevue Ave., #250 NEWPORT, RI 02840 888.244.3417		
DESCRIPTION	18 X 18 X 12D FLOOR SINK 4 SCH10	PART #	FS-181812-B41
MATERIAL	Stainless Steel	WEIGHT	88.10
PVC SPEC INST.			
			ALL DIMENSIONS ARE IN INCHES UNLESS NOTED